



Corner Cottage, Michlow Lane, Smalldale, Bradwell, Hope Valley,

Saxton Mee

Michlow Lane, Smalldale Bradwell

Asking Price

£250,000

This spacious two double bedroom character cottage offers an excellent opportunity to enjoy village life in the heart of the Peak District. Occupying an end terrace position, the property enjoys delightful open views across the recreation ground and rolling countryside beyond.

The accommodation is both welcoming and generously proportioned, beginning with a charming sitting room centred around a Derbyshire stone fireplace with a multi-fuel stove, providing a warm and characterful focal point. The fitted breakfast kitchen offers a practical and inviting space, while upstairs there are two spacious double bedrooms and a bathroom, making the cottage ideal as a permanent home, weekend retreat or holiday property.

With an easily managed courtyard garden. To the rear is a useful former outside W.C. and store, providing additional storage.

Situated in the highly sought-after village of Bradwell, the cottage is perfectly positioned to enjoy everything this thriving Peak District community has to offer. Bradwell is renowned for its welcoming atmosphere, independent shops, traditional country pubs, café, primary school and strong sense of community, all set against the backdrop of some of England's most spectacular scenery.



- Traditional Derbyshire Cottage
- Beautifully Presented Throughout
- Spacious Light & Airy
- Feature Fireplace With Log Burning Stove
- Picturesque Setting
- Popular Peak Park Village
- Ideal Main Home Or Holiday Cottage
- Garden Store & Easily Managed Courtyard Garden
- Energy Rating D
- Viewing: Hathersage Office





Corner Cottage

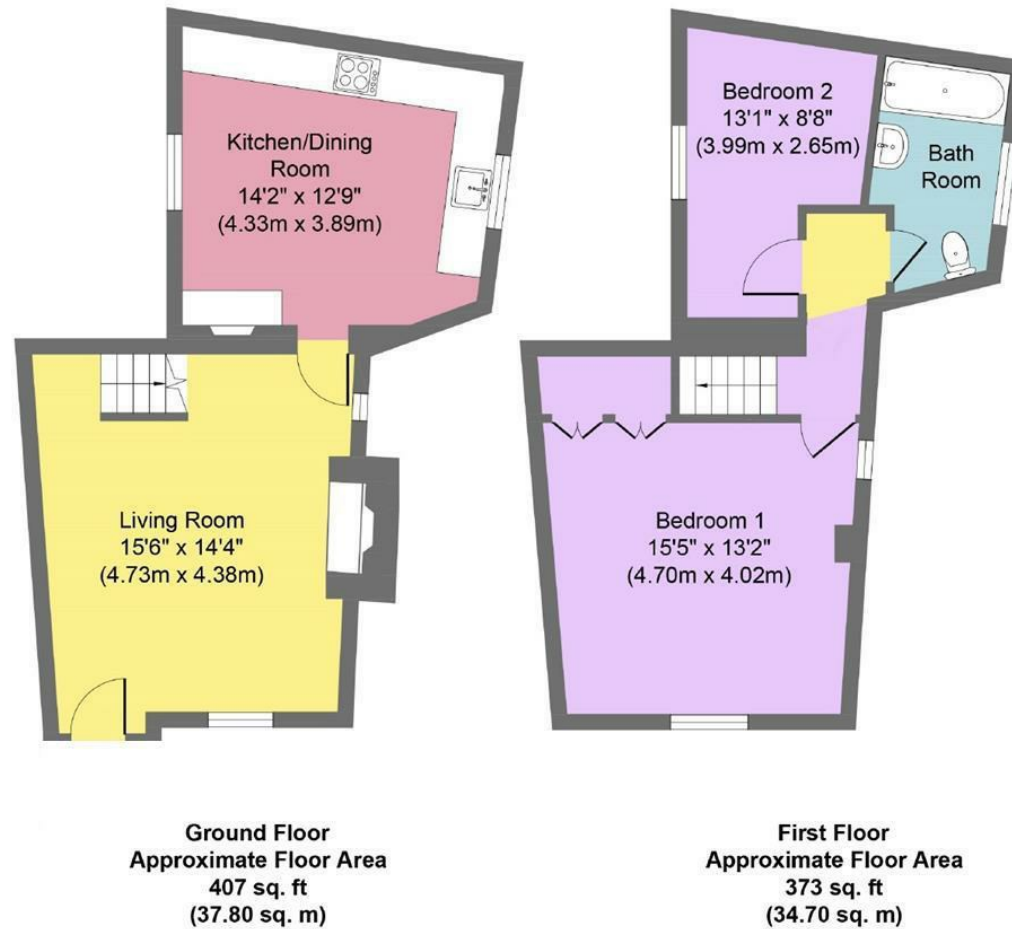

Illustration for identification purposes only, measurements are approximate, not to scale.

While we endeavour to make our sales particulars fair, accurate and reliable, they are only a general guide to the property and, accordingly, if there is any point, which is of particular importance to you, please contact the relevant office. The Agents have not tested any apparatus, equipment, fittings or services and so cannot verify they are in working order. The buyer is advised to obtain verification. Please note all the measurement details are approximate and should not be relied upon as exact. All plans, floor plans and maps are for guidance purposes only and are not to scale. Under no circumstances should they be relied upon as exact or for use in planning carpets and other such fixtures, fittings or furnishings. YOUR HOME IS AT RISK IF YOU DO NOT KEEP UP REPAYMENTS ON A MORTGAGE OR OTHER LOAN SECURED ON IT. 'A Life Assurance policy may be requested.' 'Written Quotations of credit terms available on request.'

Banner Cross
T: 0114 268 3241
E: bannercross@saxtonmee.co.uk
www.saxtonmee.co.uk

Hathersage
T: 01433 650009
E: hathersage@saxtonmee.co.uk

Bakewell
T: 01629 815307
E: bakewell@saxtonmee.co.uk

Matlock
T: 01629 828250
E: matlock@saxtonmee.co.uk

